

ESC250D

Field Assembly Optical Connector
现场组装式光纤活动连接器

Installation Manual 操作说明书

- ◆ To use this product correctly, the instructions must be read carefully before use.
为正确使用本产品，使用前务必读本说明书。
- ◆ Please assemble the connector according to these instructions, using the matched tools.
请按照说明书，使用配套工具组装连接器。
- ◆ The specific operation example is referred to ESC250D-APC.
具体操作示例以ESC250D-APC为参考。
- ◆ The product picture of this instruction is only for reference, please make the object as the standard.
本说明书产品颜色仅做示意，请以实物为准。

Product components 产品组成部件

ESC250D-UPC

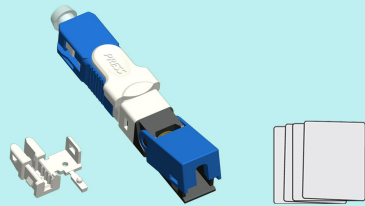

ESC250D-APC

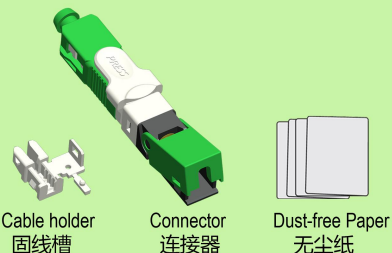

Operation steps 操作步骤

Cable Stripper
皮线开剥钳

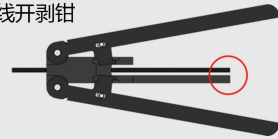

1. Insert the cable into the cable stripper, strip the cable as per the markings.
将光缆穿入开剥钳，对齐标尺开剥外皮。

Cutting Jig
定长工具条

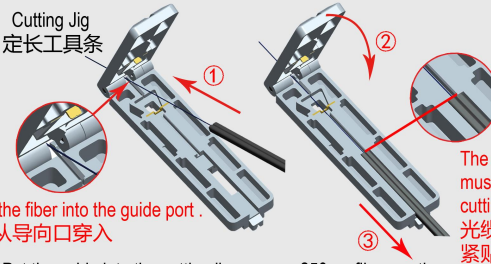

Insert the fiber into the guide port.
光纤从导向口穿入

The cable jacket must meet the cutting jig limit.
光缆切口紧贴限位处

2. Put the cable into the cutting jig, remove 250um fiber coating.
用定长工具条定位光缆，定长开剥250um涂覆层。



Bend the fiber to four directions of 60° to check whether damage.
用手指轻压光纤向前、后、左、右至60°，检测光纤是否受损。

3. Check the fiber and clean the fiber.
检查光纤是否受损伤，并清洁光纤。

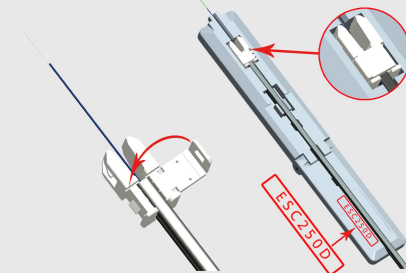

Fiber Cleaver
光纤切割刀

The cutting jig must meet the fiber cleaver stopper.
定长工具条紧贴切割刀定位处

5. Cut the bare fiber.
定长切割裸光纤。

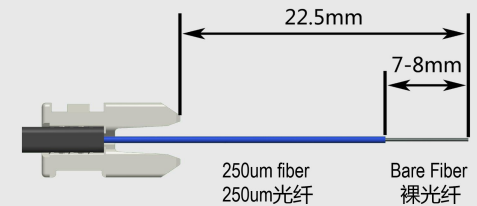

6. Cutting length. (Picture shown only for reference)
光纤切割尺寸（仅数值参考）

4. Fix the cable 固定光缆

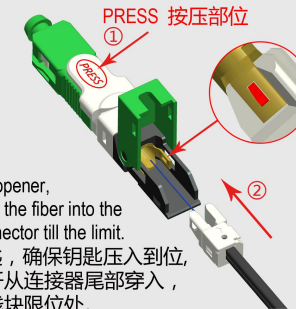

PRESS 按压部位

Limit
导线块限位

7. Press the opener, then insert the fiber into the tail of connector till the limit.
按压钥匙，确保钥匙压入到位，再将光纤从连接器尾部穿入，直至导线块限位处。

Fiber bending 光纤形成微弯

8. Press the cover, remove the opener, complete the assembly.
先合上方盖，再取下钥匙，完成组装。

Repeat assembly 重复开启步骤

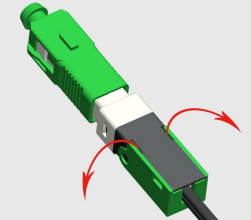

- (1) Remove the rear cover from two sides.
用指尖从弹簧座缺口处两侧向外轻掰开方盖，使方盖与弹簧座分离。

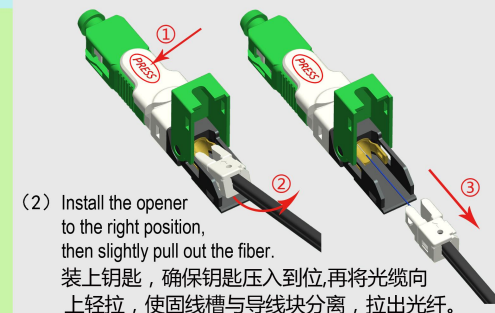

- (2) Install the opener to the right position, then slightly pull out the fiber.
装上钥匙，确保钥匙压入到位，再将光缆向上轻拉，使固线槽与导线块分离，拉出光纤。

- (3) Open the cable holder and pull out the cable, complete the repeat assembly.
打开固线槽，取出光缆，完成重复开启操作。

Notes for cable holder 两用固线槽使用须知：

2.0*3.0mm drop cable 皮线光缆：



Remove
尾部去除

2.0*1.6mm drop cable 皮线光缆：

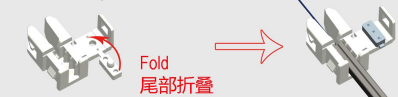

Fold
尾部折叠