

CNT-4F 4 core FTTH Terminal Box

1. Description:

- It is used for different kinds of modules and applied to the working area subsystem.
- It uses embedded surface frame, easy to install and disassemble, it is with protective door and dusty free, can do OEM for any customers and print requested LOGO.
- With application of fiber SC/LC simplex, duplex and other different environment installed plate or flush plate. All modules can be configured on customer's choice.
- Cable management can be connected without cutting(with express port) . All modules are free of welding.

2、Working area:

- The telecommunication network, metropolitan area network, optical fiber communication system.
- Optical testing equipment/instrument.
- CATV optical fiber, optical fiber sensor.
- Optical fiber broadband access network, FTTH optical fiber.
- Optical fiber distribution frame, frame type and wall type optical fiber distribution unit.

3、Configuration table:

Model No.	CNT-4F
Dimension(LXWXH) mm	100.6X80.6X28.8
Installation	Wall mounting(Indoor/Outdoor)
Cable Entries	Supporting Uncut
Max Cable Diameter	Max Input=2.0X5.0mm Max Output= --
No. Of Adapters & Splitters	4 pcs SC SX, 4 pcs LC DX
Packing Information	G.W.:17.5kg QTY.:187 pcs/Carton MEAS.:52x36x39cm

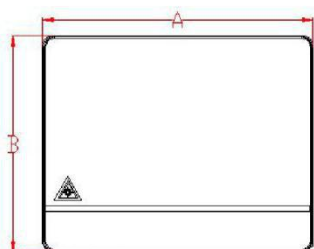

Pic 1 Box Size

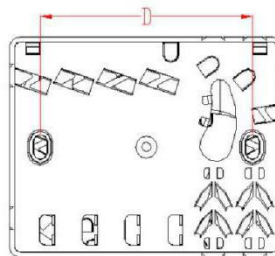
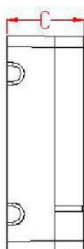

Pic 2 Installation Size

4、Product inside structure and cable ways:

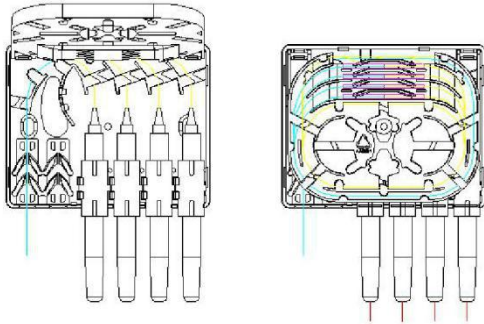

Pic 3 Cable ways

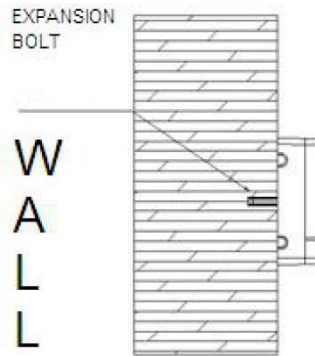

Pic 4 Wall-mounted installation

5.Pictures

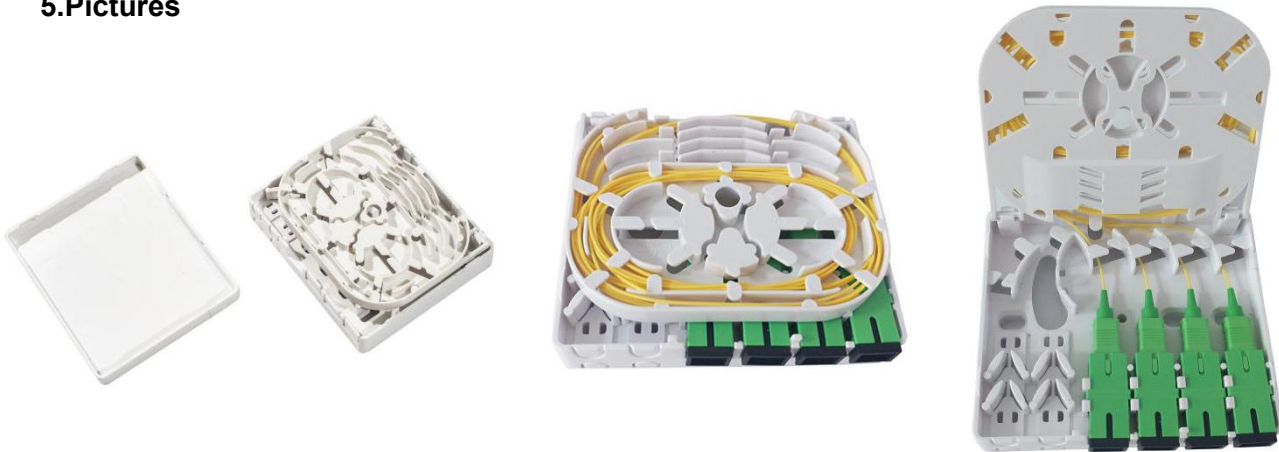

6. Installation:

1.Wall-mounted installation

Drill 2 holes over the wall based on the size in table 1, place the expansion bolt $\Phi 5.5 \times 30$, place the box to match up the holes and use bolt to fasten. (see Pic 4)

7、Accessories:

1. User Manual*1.
2. Accessories Bag*1.